

CARE INSTRUCTIONS & WARRANTY INFORMATION FOR YOUR TAP

Thank you for purchasing a TapSpares UK Rivaro kitchen tap.

Care & Maintenance

Your tap's finish has a 1 year guarantee. Wipe over the tap using a cloth and washing liquid if required, rinse and dry with a soft cloth.

Please do not use abrasive sponges or strong cleaners, including bleach, to clean your tap. These could damage your tap's finish and void the guarantee.

Guarantee

This product is guaranteed against any mechanical defect for 2 years. You should retain your dated invoice as proof of purchase to validate any claims under our guarantee. The guarantee will be valid from the date of purchase as shown on the sales invoice. This tap is intended for domestic use only. The guarantee does not apply to products installed outside a domestic environment.

What is covered by the warranty?

The repair or replacement of all or part of your tap if your tap is found to be defective due to faulty materials or manufacture within the relevant guarantee period at TapSpares UK's discretion.

If any part is no longer available, or out of manufacture, TapSpares UK reserve the right to replace it with a suitable alternative.

What is not covered by the warranty?

- Faulty installation, repairs or alterations not in accordance with the installation guide.
- Normal wear and tear.
- Accidental damage or faults caused by negligent use or care; misuse; neglect or careless operation.
- The use of anything other than genuine replacement parts.

Terms & conditions of the warranty

The guarantee is valid for the UK.

The guarantee becomes effective at the date of purchase or at the date of delivery if this is later.

Proof of purchase is required under the terms of the guarantee.

The guarantee provides benefits in addition to your statutory consumer rights.

How do I claim under my guarantee?

If you wish to discuss a claim, please call TapSpares UK on 01603 559096 Monday to Friday, between the hours of 9.00am and 4.00pm. Alternatively, you can email support@tapsparesuk.com.

TAP SPARES

RIVARO *Collection*

Modina Filter

TS1949



INTRODUCTION

This product has been designed and manufactured to the very highest quality standards. Correctly installed and properly maintained in accordance with the following instructions, it will provide you with many years of reliable service.

If you are considering carrying out the installation of your tap as a DIY project, we respectfully suggest you consider the risks associated with installing water appliances. TapSpare UK recommends you engage the services of a qualified installer.

The installation must be carried out in strict accordance with the instructions provided and comply with the UK Water Supply (Water Fittings) Regulations 1999 and safety standards.

INSTALLATION REQUIREMENTS

Hole size: \varnothing 35mm

Max depth: 50mm

Connections: G1/2"

Minimum water pressure: 7PSI (0.5 bar)

Maximum water pressure: 75PSI (5 bar)

Maximum hot water temperature: 80°C

Recommended hot water temperature: 65°C

Single flow spout, ideally installed with equal supply pressures

Important Note: Exceeding these temperatures or water pressures can result in damage to the tap. A pressure reducing valve should be fitted in high water pressure situations.

BEFORE YOU BEGIN

Before installing the tap, it is essential that you thoroughly flush through the supply pipes in order to remove any remaining swarf, solder or other impurities. Failure to carry out this simple procedure could cause problems or damage to the workings of the tap.

Locate the existing hot and cold water supply pipes. **Important Note:** Ensure the flexible hoses are within comfortable reach of their respective connection points, without them having to be compressed, stretched or kinked.

We recommend the installation of isolation valves on both water supplies to assist with future servicing requirements.

Shut off the mains water supply.

INSTALLING THE FILTER

1. Write the installation and replacement date onto the filter case label.
2. If suitable, use a self tapping screw (15) to attach the mounting bracket (14) to the kitchen cabinet inside wall, place the filter in an accessible location near to both the Water Filter System and the cold water supply. Clip the filter into mounting bracket (14).
3. Push the black tubing (18) firmly into the push fit connectors located on the 'T' piece (19) and the isolation valve (17). Push the isolation valve (17) onto the inlet tube of the filter. Remove the dust caps from the filter and firmly push.
4. Tip: If you wish to shorten the length of the black tube it must be cut squarely using a sharp blade.
5. Tip: When making push-fit connections, it is a good idea to wet the end of the tube.

INSTALLING THE TAP

1. Screw in the fixing stud (7) into the base of the tap. Pass the base ring and worktop seal (3) over the fixing bolt (7) onto the base of the tap (1).
2. Screw the hot and cold G1/2" supply flexes (16) and the filter push-fit supply flex (9) into the rear. Take care not to damage the tail pipes.
3. Pass the supply flexes and fixing bolt (7) through the work surface or sink (4) from the top side. Place the tap (1) so it covers the 35mm tap hole. Rotate the spout and body so the tap is facing forwards.
4. Pass the rubber 'C' seal (5) and then the metal clamp plate (6) over the fixing bolt (7) and up to the underside of the worktop or sink. Compress the tap down to the worktop or sink by tightening nut (8) [12mm AF] over the fixing bolt (7). Take care not to over tighten the nut (8). An optional sink support is provided for additional stability on sheet metal sinks.
5. Push-fit the connector (11) on filtered supply flex (9) firmly onto the outlet of the filter (12)
6. Connect the 'T' piece (19) to the cold water supply flex ensuring the seal (20) is in place and free from debris.
7. Connections to the hot and cold supply feeds can now be made. With the tap valves open, gradually open the supply feeds.
8. Check the installation for leaks and before use, flush 20 litres of water through the system (approx 10 minutes). Water may be discoloured at first, which is normal. Your tap is now ready for use (as a precaution we recommend checking for leaks again before retiring for the night).

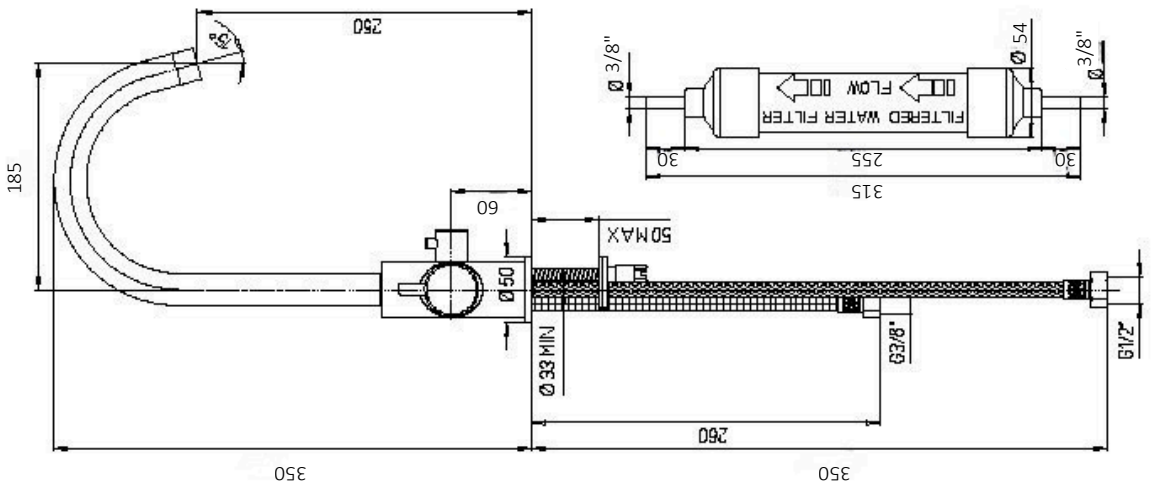
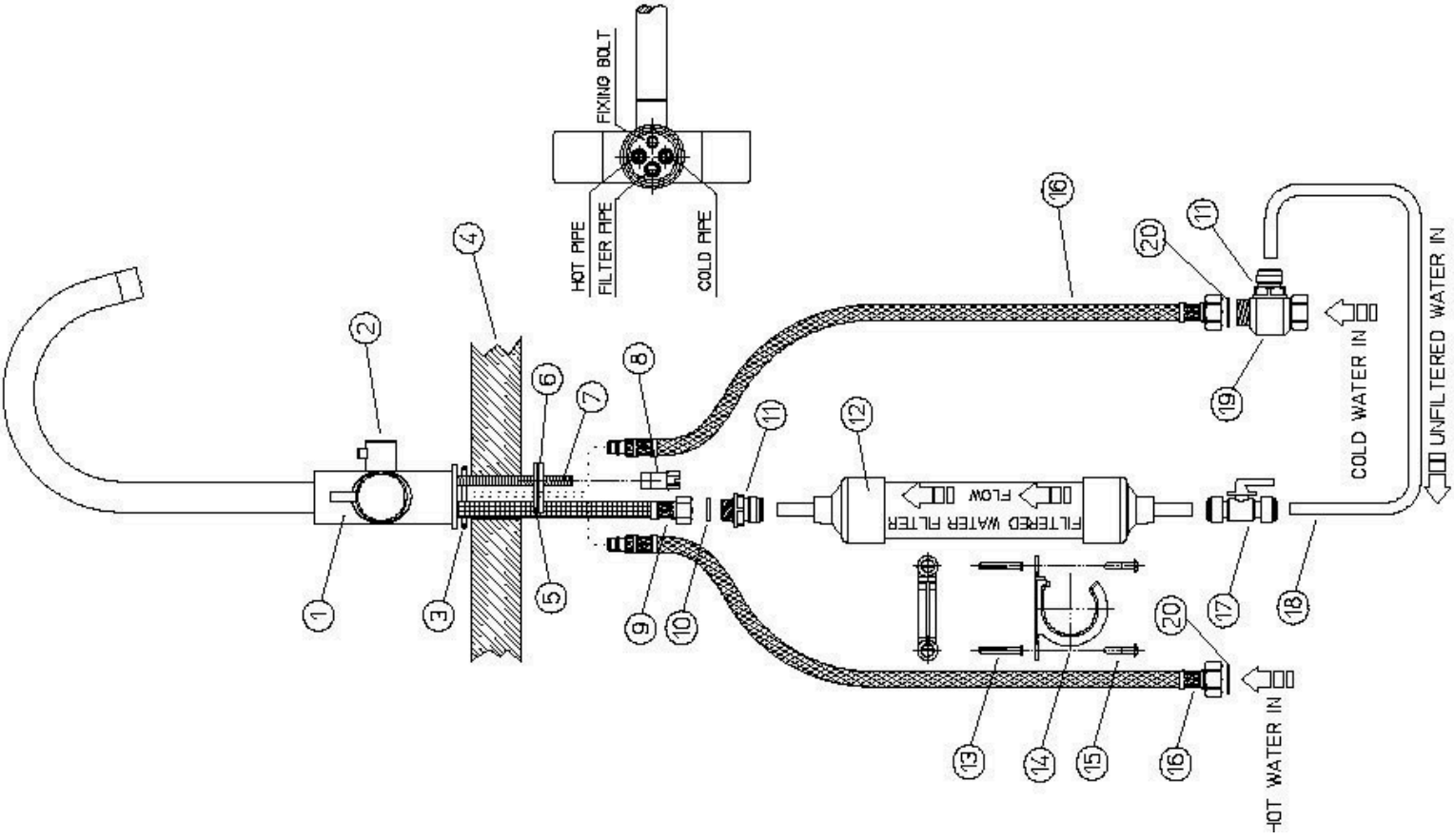

REPLACING THE FILTER

1. Place a bowl underneath the filter to prevent any water spillage.
2. Locate the saddle valve and turn the handle in a clockwise direction until it stops.
3. Open the filter handle located on the tap above the sink and wait until water stops running. This relieves any pressure in the system.
4. Hold the existing filter cartridge with one hand.
5. Remove the isolation valve by pressing down the push-fit ring whilst simultaneously pulling the isolation valve away from the filter. Use a special key tool or 10mm spanner to assist you if needed.
6. Repeat the procedure at the other end of the filter.
7. Before fitting the new filter, write the installation date in the space provided on the label.
8. Remove dust caps from the new filter and, making sure that the flow arrow is in the correct direction (arrow pointing towards the tap), push the adaptors firmly onto the filter. The filter should be securely fixed back into securing bracket.
9. Open the filter handle on the tap and then turn on the isolation valve by rotating the handle anticlockwise.

ATTENTION

Before use, flush at least 20 litres of water through the system (approx 10 minutes). Water may be discoloured at first, which is normal.

